



15 Providence Place

Abbey Street, Farnham, GU9 7RQ

A first floor double bedroom retirement flat overlooking the communal garden situated close to Farnham town centre and Gostrey Meadows. No onward chain.

Price Guide £150,000

15 Providence Place

Abbey Street, Farnham, GU9 7RQ



- Close to Farnham town centre and railway station
- Double bedroom
- Airing/storage cupboard
- No onward chain
- Lift or stairs
- Kitchen
- Communal residence lounge, laundry room, garden and parking
- Sitting room with views over the communal garden
- Bathroom
- Retirement flat with entry phone system

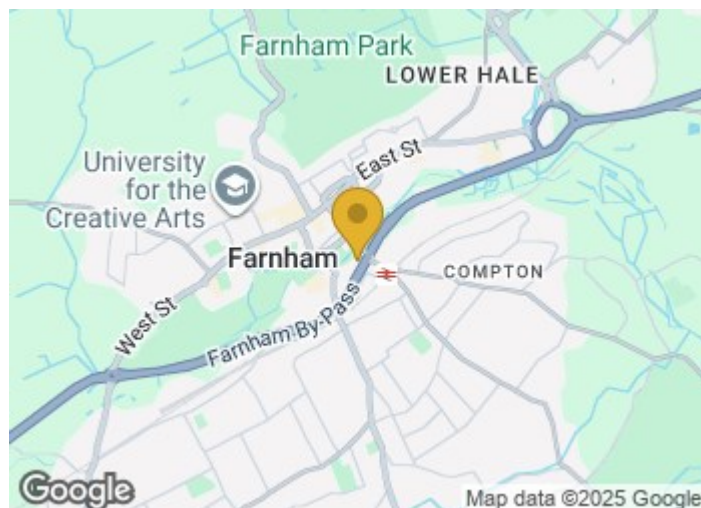

Directions





Floor Plan

FIRST FLOOR

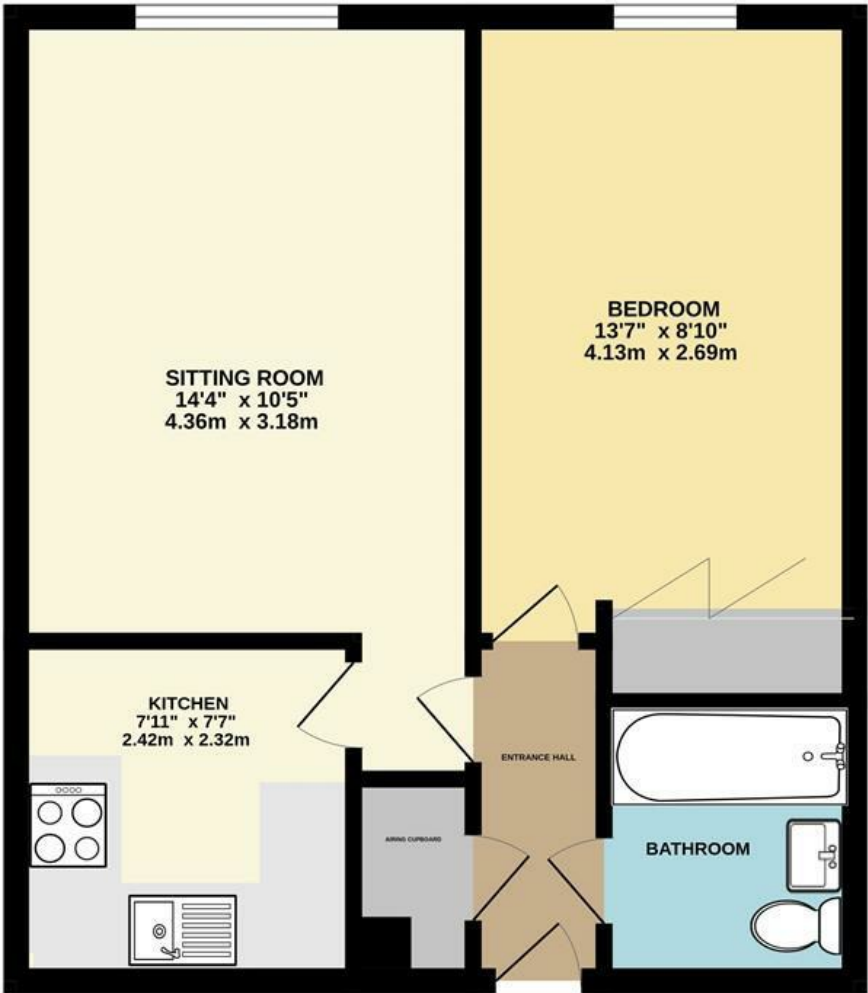

Whilst every attempt has been made to ensure the accuracy of the floorplan contained here, measurements of doors, windows, rooms and any other items are approximate and no responsibility is taken for any error, omission or mis-statement. This plan is for illustrative purposes only and should be used as such by any prospective purchaser. The services, systems and appliances shown have not been tested and no guarantee as to their operability or efficiency can be given.
Made with Metropix ©2025

These particulars, whilst believed to be accurate are set out as a general outline only for guidance and do not constitute any part of an offer or contract. Intending purchasers should not rely on them as statements of representation of fact, but must satisfy themselves by inspection or otherwise as to their accuracy. No person in this firms employment has the authority to make or give any representation or warranty in respect of the property.

